

Accessories

Mattress / Side Rail / Bed Grip / Table

Mattress



Breathable
Outer cover is detachable and washable

Waterproof
Outer cover is detachable and washable by hand

Reversible Urethane Foam Mattress

UB Point Mattress

PM09-A9008 (Width 90cm)
PM09-A8308 (Width 83cm)

Material: Outer Cover: Polyester
Interlining: Urethane foam

PD503-A9008 (Width 90cm)
PD503-A8308 (Width 83cm)

Material: Outer Cover: Polyurethane laminate, Polyester
Interlining: Urethane foam

Width 90cm Size: width 90.0cm x height 8.0cm x length 191.0cm
Weight: 6.1kg Country of Manufacture: Vietnam

Width 83cm Size: width 83.0cm x height 8.0cm x length 191.0cm
Weight: 5.7kg Country of Manufacture: Vietnam

BREATHABLE

WATER PROOF

Reversible type for stiffness selection

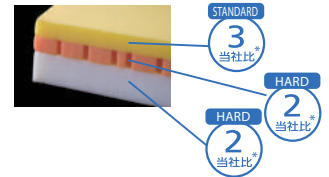

Outer cover is detachable and washable

Pressure Relief Mattress

Standard Mattress

PKM-E80BR

FLAME RESISTANT ANTI BACTERIAL DEODORANT MITE CONTROL

Material: Polyester
Size: width 90.0cm x height 8.0cm x length 191.0cm
Weight: 6.2kg Country of Manufacture: Korea

Double layer to relieve compression on the back

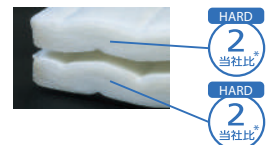

Outer cover and inner cover are detachable and washable

Polyester Mattress with Good Ventilation

New Point Mattress

PKM-9080 (Width 90cm)
PD504-A8308 (Width 83cm)

Material: Polyester

Width 90cm Size: width 90.0cm x height 8.0cm x length 191.0cm
Weight: 7.5kg Country of Manufacture: Korea

Width 83cm Size: width 83.0cm x height 8.0cm x length 192.0cm
Weight: 7.2kg Country of Manufacture: Korea

FLAME RESISTANT ANTI BACTERIAL DEODORANT MITE CONTROL

Double layer of different firmness of polyester

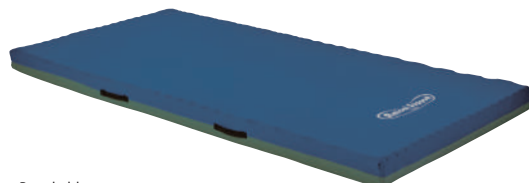
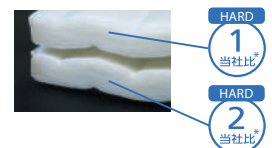

Breathable
Outer cover is detachable and washable

Waterproof
Outer cover is detachable and washable by hand

High grade urethane foam mattress excellent in dispersing body pressure and following capability that moves to fit the reclining mechanism

Amical Support Mattress

PM11-9009 (Width 90cm)
PM11-8309 (Width 83cm)

Material: Outer Cover: Polyester
Interlining: Urethane foam

PM12-9009 (Width 90cm)
PM12-8309 (Width 83cm)

Material: Outer Cover: Polyurethane laminate, Polyester
Interlining: Urethane foam

Width 90cm Size: width 90.0cm x height 9.0cm x length 191.0cm
Weight: 5.5kg Country of Manufacture: Japan

Width 83cm Size: width 83.0cm x height 9.0cm x length 191.0cm
Weight: 5.0kg Country of Manufacture: Japan

FLAME RESISTANT (BACKSIDE) MRSA ANTI BACTERIAL ANTI BACTERIAL BREATHABLE

FLAME RESISTANT (BACKSIDE) MRSA ANTI BACTERIAL ANTI BACTERIAL WATER PROOF

Reversible type for stiffness selection

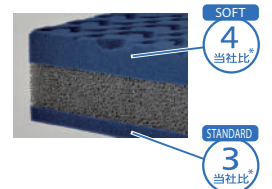

High flexible urethane foam excellent in following capability to fit the reclining mechanism



Side Rail

For Nursing Care Bed, Care Facility Bed

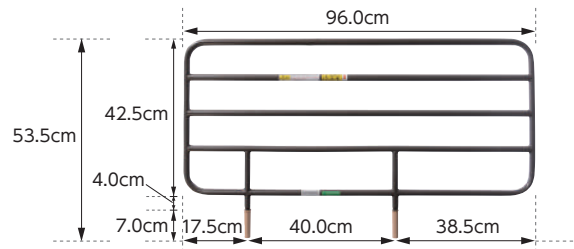

Long Side Rail (2 pieces set)

PA505-96

Material: Steel, PA Weight: 6.8kg (2pcs) Country of Manufacture: Vietnam

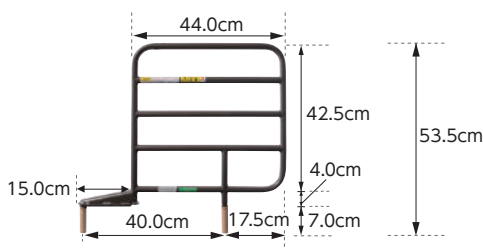

Short Side Rail (2 pieces set)

PA505-44

Material: Steel, PA, PP Weight: 4.5kg (2pcs) Country of Manufacture: Vietnam

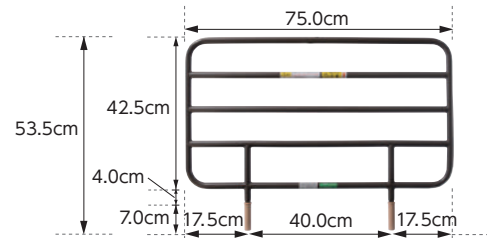

Regular Side Rail (2 pieces set)

PA505-75

Material: Steel, PA Weight: 5.4kg (2pcs) Country of Manufacture: Vietnam

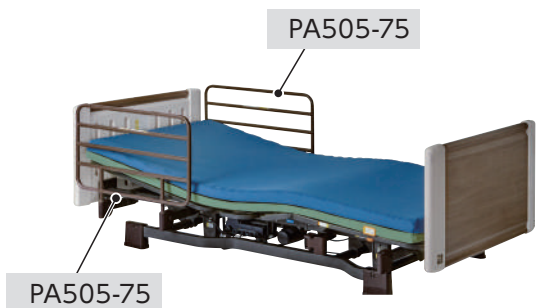

Example when used with Miolet II

For Hospital Bed

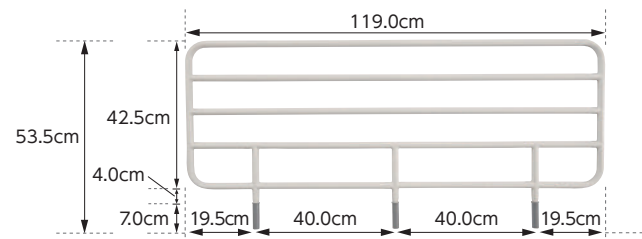

Long Side Rail (1 piece set)

PS01-119

Material: Steel, PA Weight: 4.0kg Country of Manufacture: Vietnam

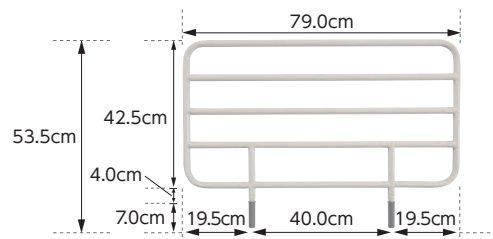

Regular Side Rail (2 pieces set)

PS01-79

Material: Steel, PA Weight: 5.5kg (2pcs) Country of Manufacture: Vietnam

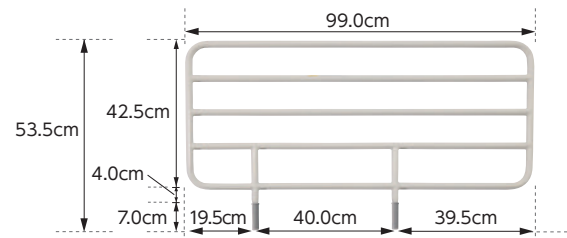

Long Side Rail (2 pieces set)

PS01-99

Material: Steel, PA Weight: 6.8kg (2pcs) Country of Manufacture: Vietnam

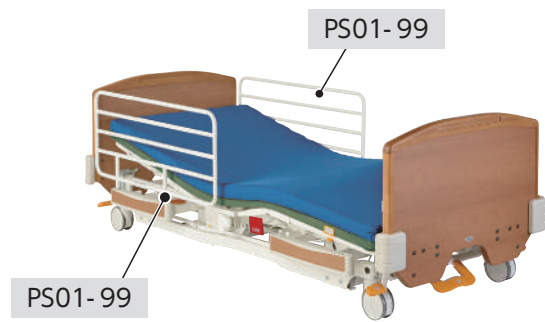

Example when used with P300 series

Collapsible Side Rail

For Nursing Care Bed , Care Facility Bed, Hospital Bed

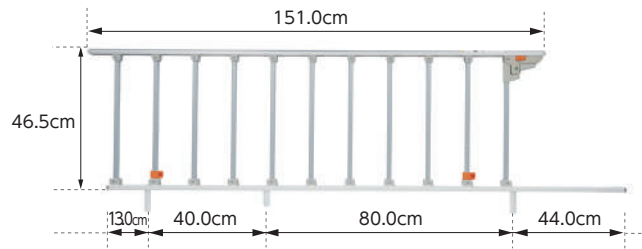

Long Type (1 piece set)

PS05-151

Material: Steel, ABS Weight: 5.4kg Country of Manufacture: Vietnam

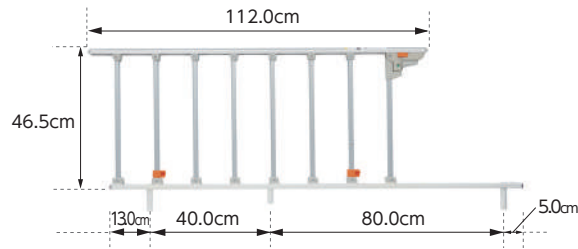

Short Type (1 piece set)

PS05-112

Material: Steel, ABS Weight: 4.4kg Country of Manufacture: Vietnam

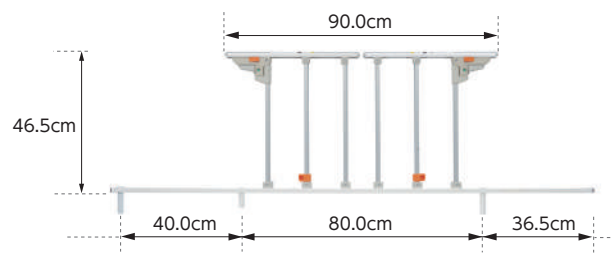

Separate Type (1 piece set)

PS05-90

Material: Steel, ABS Weight: 4.3kg Country of Manufacture: Vietnam

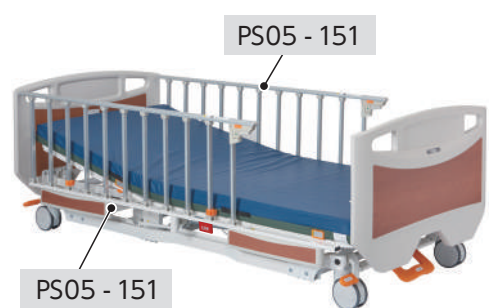

Example when used with P300 series

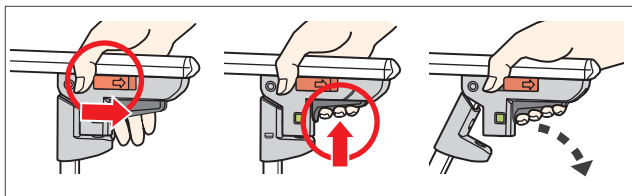

Double Locks System

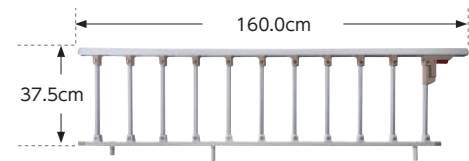

Long Type (2 pieces set)

PS04-158

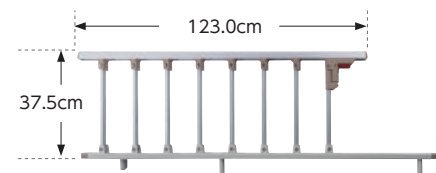

Short Type (2 pieces set)

PS04-120



Example when used with Ardel

Bed Grip

This series supports No-Lifting Policy

Kneeparo +(Plus)

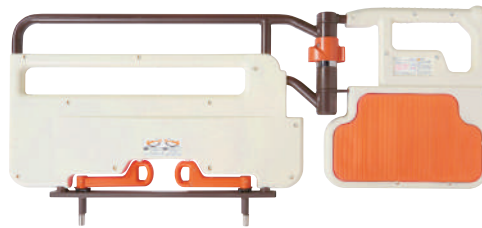

Auto lock bed grip (Kneeparo Plus) PG02-116ATP

Material: Steel, Zinc die-cast, ABS, POM, EVA
Weight: 9.2kg
Country of Manufacture: Vietnam

Universal design for easy lock even for users with weak grip



Universal design of requiring palm or fingers to release



Simple Installation to Bed

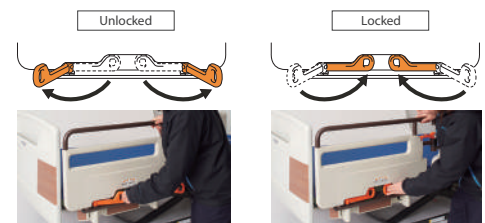

With the knee pad...



● Slip off prevention

Knee is positioned on the pad and can prevent bended knee



● Stabilizes sitting upright

At 45 degrees angle, knees are fixed and falling off can be prevented



● Easy stand up

By pressing the knee onto the pad and pull the arm, the hip can be lifted easily and you can stand up with a little force



● Stable stand

Standing position is more stable since it supports the body at 3 positions; arms, knee and leg

Table



Over Bed Table

PGT-400LM (For 90cm Wide Bed)

PGT-400LM83 (For 83cm Wide Bed)

Material: Print Coating Fiberboard, ABS Weight: 3.2kg (width 90cm), 3.0kg (width 83cm) Load Capacity: 15kg Country of Manufacture: Taiwan



Gas Lift Adjustable Table

PZT-840

Material: Base frame: Steel
Wooden part: Synthetic resin decorative fiberboard (Melamine)
Caster cover: PP
Weight: 15.5kg Load Capacity: 10kg Country of Manufacture: Vietnam